

MACHINE PARTS CHART
for
SINGER*

81U71

* A Trademark of THE SINGER COMPANY

© THE SINGER COMPANY 1968

From the library of: Superior Sewing Machine & Supply LLC

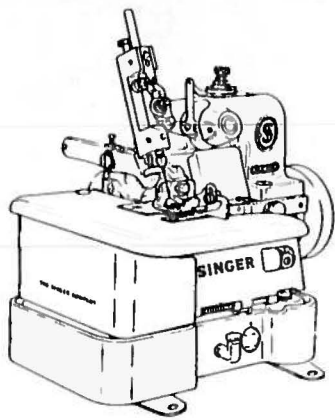

SINGER^{*}

81U71

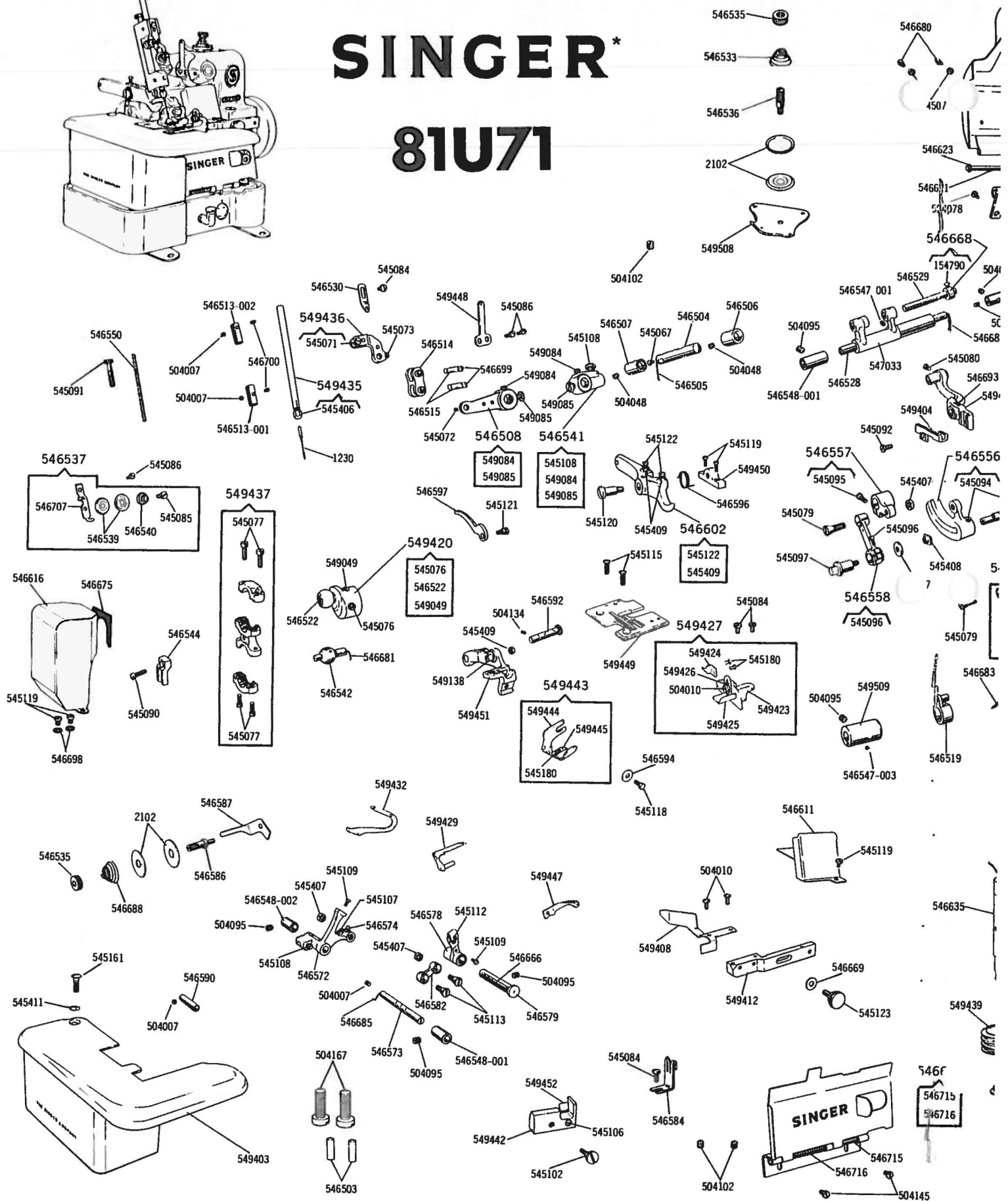

NUMERICAL LIST OF PARTS FOR MACHINE 81U71

| PART NO. | DESCRIPTION | PART NO. | DESCRIPTION | PART NO. | DESCRIPTION |
|--------------|---|--------------|---|--------------|---|
| 2102 | Tension (looper, left hand) Disc (2) | 504507 (809) | Thread Guide (looper, right hand) Lock Nut (2) | 545115 (829) | Throat Plate Screw (2) |
| 2102 | Tension (looper, right hand) Disc (2) | 504509 (809) | Frame Back Cover Thumb Screw Nut | 545118 (853) | Presser Foot Screw |
| 2102 | Tension (needle thread) Disc (2) | 545049 (805) | Oil Pump (screw pump) Screw Locking Screw | 545119 (853) | Frame Top Cover Screw |
| 154790 (850) | Feed Bar Hinge Pin Collar Set Screw | 545050 (805) | Oil Pump (screw pump) Screen Frame Screw (3) | 545119 (853) | Lifting Lever Bracket Screw (2) |
| 504007 (850) | Feed Eccentric Set Screw (2) | 545067 (821) | Needle Bar Crank Shaft Plug Screw | 545119 (853) | Looper (right hand) and Spreader Lever Connection Cover Screw (2) |
| 504007 (850) | Feed Rock Shaft Hinge Pin Plug Screw | 545071 (853) | Needle Bar Connecting Bracket Clamping Screw | 545120 (829) | Lifting Lever Hinge Screw |
| 504007 (850) | Looper (right hand) and Spreader Lever Hinge Pin Plug Screw | 545072 (833) | Needle Bar Connecting Link Hinge Pin Set Screw | 545121 (810) | Presser Lever Lifter Hinge Screw |
| 504007 (850) | Needle Bar Bushing (lower) Set Screw | 545073 (853) | Needle Bar Connecting Link Hinge Pin Set Screw | 545122 (853) | Lifting Lever Stop Screw (2) |
| 504007 (850) | Needle Bar Bushing (upper) Set Screw | 545074 (805) | Frame Screw (4) | 545123 (852) | Feed Eccentric Cover Holder Thumb Screw |
| 504007 (850) | Oil Pump (screw pump) Screw Shaft Gear Set Screw (2) | 545076 (833) | Frame Rotary Shaft Crank Position Screw | 545124 (850) | Balance Wheel Set Screw |
| 504007 (850) | Thread (looper, left hand) Tube Set Screw | 545077 (850) | Looper (right hand) and Spreader Lever Connection Cap Screw (4) | 545125 (850) | Balance Wheel Position Screw |
| 504010 (829) | Feed Eccentric Cover Holder Oil Guard Screw (2) | 545077 (850) | Needle Bar Connecting Rod Cap Screw (4) | 545130 (810) | Frame Back Cover Thumb Screw |
| 504010 (829) | Frame Back Cover Lock Spring Screw (2) | 545078 (803) | Feed Connecting Rod Cap Screw (2) | 545131 (809) | Oil Tube Joint Bolt (large) (3) |
| 504010 (829) | Guide Smoothing Plate Screw | 545079 (850) | Feed Connecting Rod Hinge Screw | 545132 (809) | Oil Tube Joint Bolt (small) (4) |
| 504010 (829) | Oil Tube Holder Screw (3) | 545079 (850) | Feed Regulator Connection Hinge Screw | 545161 (829) | Cloth Plate Hinge Screw |
| 504048 (833) | Feed Lifting Eccentric Set Screw (2) | 545080 (803) | Feed Bar Hinge Pin Set Screw | 545179 (803) | Oil Flow Regulating Pin Clamp Screw |
| 504048 (833) | Needle Bar Crank Shaft Bushing (back) Set Screw | 545084 (853) | Guide Body Screw (2) | 545180 (803) | Guide Finger Screw (2) |
| 504048 (833) | Needle Bar Crank Shaft Bushing (front) Set Screw | 545084 (853) | Thread (looper, right hand) Staple Screw | 545180 (803) | Presser Foot Chaining-off Finger Screw |
| 504048 (833) | Oil Gauge Window Plug Screw | 545084 (853) | Thread (needle) Eyelet Screw | 545406 (853) | Needle Clamping Nut |
| 504048 (833) | Oil Tube Joint Frame Plug Screw | 545085 (829) | Needle Bar Thread Retainer Screw | 545407 (819) | Feed Connecting Rod Hinge Screw Nut |
| 504071 (833) | Oil Pump (screw pump) Body Screw (3) | 545086 (829) | Needle Bar Thread Retainer Bracket Screw | 545407 (819) | Feed Regulator Connection Hinge Screw Nut |
| 504078 (803) | Frame Back Cover Bracket Screw (2) | 545086 (829) | Thread (needle) Take-up Screw (2) | 545407 (819) | Looper (left hand) Lever Connecting Link Hinge Screw Nut (2) |
| 504095 (850) | Feed Rock Shaft Hinge Pin Bushing (left) Set Screw | 545090 (803) | Looper (right hand) and Spreader Lever Connection Guide Screw | 545408 (803) | Feed Regulating Screw Stud Nut |
| 504095 (850) | Feed Rock Shaft Hinge Pin Bushing (right) Set Screw | 545090 (803) | Needle Bar Connecting Rod Guide Screw | 545409 (821) | Lifting Lever Stop Screw Nut (2) |
| 504095 (850) | Frame Rotary Shaft Bushing (front) Set Screw | 545091 (829) | Presser Regulating Thumb Screw | 545409 (821) | Presser Lever Screw Stud Nut |
| 504095 (850) | Frame Rotary Shaft Flanged Bushing (back) Set Screw | 545092 (803) | Feed Dog Screw | 545411 (805) | Cloth Plate Hinge Screw Nut |
| 504095 (850) | Looper (left hand) Lever Hinge Stud Set Screw | 545094 (833) | Feed Regulator Set Screw (2) | 545857 | Oil Pump (screw pump) Screen |
| 504095 (850) | Looper (right hand) and Spreader Lever Hinge Pin Bushing (back side) Set Screw | 545095 (803) | Feed Rock Shaft Crank Clamping Screw | 545858 | Oil Pump (screw pump) Screen Frame |
| 504095 (850) | Looper (right hand) and Spreader Lever Hinge Pin Bushing (front side) Set Screw | 545096 (803) | Feed Regulator Connection Adjusting Screw | 546503 | Arm Dowel Pin (2) |
| 504102 (833) | Arm Oil Hole Plug Screw | 545097 (803) | Feed Regulating Screw Stud | 546504 | Needle Bar Crank Shaft |
| 504102 (833) | Frame Oil Hole Plug Screw (2) | 545102 (850) | Needle Guard Holder Set Screw | 546505 | Needle Bar Crank Shaft Oil Wick |
| 504130 (850) | Machine Base and Oil Reservoir Oil Drain Cap Screw | 545106 (850) | Needle Guard Screw | 546506 | Needle Bar Crank Shaft Bushing (front) |
| 504134 (850) | Presser Lever Hinge Stud Set Screw | 545107 (853) | Thread (looper, left hand) Eyelet Screw | 546507 | Needle Bar Crank Shaft Bushing (back) |
| 504136 (825) | Balance Wheel Oil Guard Screw (2) | 545108 (833) | Looper (right hand) and Spreader Lever Ball Stud Set Screw | 546508 | Needle Bar Crank (front) with 549084 (833) and 549085 (833) |
| 504145 (810) | Frame Side Cover Screw (2) | 545108 (833) | Needle Bar Crank (back) Ball Stud Set Screw | 546513-001 | Needle Bar Bushing (lower) |
| 504159 (819) | Balance Wheel Cap Screw (3) | 545109 (853) | Looper (right hand) Screw | 546513-002 | Needle Bar Bushing (upper) |
| 504159 (819) | Frame Rotary Shaft Cover Screw (5) | 545109 (853) | Thread (looper, right hand) Take-up Screw | 546514 | Needle Bar Connecting Link |
| 504167 (805) | Arm Screw (2) | 545112 (810) | Looper (left hand) Clamping Screw | 546515 | Needle Bar Connecting Link Hinge Pin (2) |
| | | 545113 (850) | Looper (left hand) Lever Connecting Link Hinge Screw (2) | 546517 | Frame Screw Washer (4) |
| | | | | 546519 | Feed Lifting Eccentric Connection |
| | | | | 546520 | Feed Lifting Eccentric with two 504048 (833) |
| | | | | 546522 | Frame Rotary Shaft Crank Oil Pad (felt) |
| | | | | 546524 | Feed Connecting Rod with two 545078 (803) |
| | | | | 546528 | Feed Rock Shaft Hinge Pin |
| | | | | 546529 | Feed Bar Hinge Pin |
| | | | | 546530 | Thread (needle) Eyelet |

NUMERICAL LIST OF PARTS FOR MACHINE 81U71

| PART NO. | DESCRIPTION | PART NO. | DESCRIPTION | PART NO. | DESCRIPTION |
|--------------|---|------------|--|--------------|--|
| 546533 | Tension (needle thread) Spring | 546587 | Tension (looper, left hand) Thread Guide | 546676 | Oil Tube Joint Washer |
| 546535 (821) | Tension (looper, left hand) Regulating Thumb Nut | 546590 | Thread (looper, left hand) Tube | 546680 | Thread Guide (looper, right hand) (2) |
| 546535 (821) | Tension (looper, right hand) Regulating Thumb Nut | 546592 | Presser Lever Hinge Stud | 546681 | Looper (right hand) and Spreader Lever Ball Stud Oil Wick |
| 546535 (821) | Tension (needle thread) Regulating Thumb Nut | 546594 | Presser Foot Screw Washer | 546681 | Needle Bar Crank (back) Ball Stud Oil Wick |
| 546536 (853) | Tension (needle thread) Screw Stud | 546596 | Lifting Lever Spring | 546682 | Needle Bar Connecting Rod Oil Wick |
| 546537 | Needle Bar Thread Retainer complete, Nos. 545085 (829), 546540, 546707 and two 546539 | 546597 | Presser Lever Lifter | 546682 | Needle Bar Connecting Rod Oil Wick |
| 546539 | Needle Bar Thread Retainer Disc (2) | 546602 | Lifting Lever with two each 545122 (853) and 545409 (821) | 546683 | Frame Rotary Shaft Oil Wick |
| 546540 | Needle Bar Thread Retainer Spring | 546611 | Frame Top Cover | 546684 | Oil Pump (screw pump) Screw Shaft Oil Wick |
| 546541 | Needle Bar Crank (back) with 545108 (833), 549084 (833) and 549085 (833) | 546612 | Frame Side Cover complete, Nos. 546715 and 546716 | 546685 | Looper (right hand) and Spreader Lever Hinge Pin Oil Wick (felt) |
| 546542 | Looper (right hand) and Spreader Lever Ball Stud | 546616 | Looper (right hand) and Spreader Lever Connection Cover | 546686 | Feed Rock Shaft Hinge Pin Oil Wick |
| 546542 | Needle Bar Crank (back) Ball Stud | 546619 | Frame Back Cover | 546688 | Tension (looper, left hand) Spring |
| 546543 | Needle Bar Connecting Rod with four 545077 (850) | 546620 | Frame Back Cover Bracket (2) | 546688 | Tension (looper, right hand) Spring |
| 546544 | Looper (right hand) and Spreader Lever Connection Guide | 546621 | Frame Back Cover Hinge Pin | 546690 | Oil Flow Check Valve Ball |
| 546544 | Needle Bar Connecting Rod Guide | 546622 | Frame Back Cover Lock Spring | 546691 | Oil Flow Check Valve Ball Spring |
| 546545 | Frame Rotary Shaft Flanged Bushing (back) | 546623 | Frame Back Cover Hinge Pin Washer (2) | 546693 | Feed Bar Oil Pad |
| 546547-001 | Oil Pad for Feed Rock Shaft | 546625 | Frame Rotary Shaft Cover Gasket | 546695 | Frame Angle Cover (front) |
| 546547-002 | Oil Pad for Frame Rotary Shaft Flanged Bushing (back) (2) | 546626 | Machine Base and Oil Reservoir | 546696 | Frame Angle Cover (back) |
| 546547-003 | Oil Pad for Frame Rotary Shaft Bushing (front) | 546627 | Machine Base and Oil Reservoir Gasket | 546697 | Machine Base and Oil Reservoir Oil Cup |
| 546548-001 | Feed Rock Shaft Hinge Pin Bushing (left) | 546628 | Oil Filter Screen (4) | 546698 | Looper (right hand) and Spreader Lever Connection Cover Screw Washer (2) |
| 546548-001 | Looper (right hand) and Spreader Lever Hinge Pin Bushing (front side) | 546629 | Oil Filter Screen Clamp (4) | 546699 | Needle Bar Connecting Link Hinge Pin Oil Wick (2) |
| 546548-002 | Feed Rock Shaft Hinge Pin Bushing (right) | 546630 | Machine Base and Oil Reservoir Oil Drain Cap | 546700 | Needle Bar Bushing Oil Wick (felt) (2) |
| 546548-002 | Looper (right hand) and Spreader Lever Hinge Pin Bushing (back side) | 546631 | Screw Gasket | 546701 | Machine Base and Oil Reservoir Oil Cup Gasket (2) |
| 546550 | Presser Lever Spring | 546632 | Oil Gauge Window | 546707 | Needle Bar Thread Retainer Bracket |
| 546555 | Feed Regulator Hinge Stud | 546633 | Oil Gauge Window Gasket | 546715 | Frame Side Cover Hinge Pin |
| 546556 | Feed Regulator with two 545094 (833) | 546634 | Oil Pump (screw pump) Body Gasket | 546716 | Frame Side Cover Hinge Pin Spring |
| 546557 | Feed Rock Shaft Crank with 545095 (803) | 546635 | Oil Pump (screw pump) Screw Shaft | 546717 | Machine Base Cushion complete |
| 546558 | Feed Regulator Connection with 545096 (803) | 546637 | Oil Pump (screw pump) Screw Shaft Gear | 546719 | Balance Wheel Oil Guard |
| 546572 | Looper (right hand) and Spreader Lever | 546638 | Feed Eccentric and Gear with two 504007 (850) | 546720 | Balance Wheel with three 504159 (819), 545124 (850) and 545125 (850) |
| 546573 | Looper (right hand) and Spreader Lever Hinge Pin | 546639 | Oil Tube Joint Frame | 547033 | Feed Rock Shaft |
| 546574 | Thread (looper, left hand) Eyelet | 546640 | Oil Tube Joint Frame Gasket | 549049 (833) | Frame Rotary Shaft Crank Set Screw |
| 546578 | Looper (left hand) Lever | 546643-001 | Oil Tube Joint (single way) (3) | 549072 (805) | Machine Base Cushion Screw (4) |
| 546579 | Looper (left hand) Lever Hinge Stud | 546643-002 | Oil Tube Joint (single way) Suction End | 549084 (833) | Needle Bar Crank (back) Position Screw |
| 546582 | Looper (left hand) Lever Connecting Link | 546644 | Oil Tube Joint (two way) (2) | 549084 (833) | Needle Bar Crank (front) Position Screw |
| 546584 | Thread (looper, right hand) Staple | 546645-001 | Oil Tube (vinyl) | 549085 (833) | Needle Bar Crank (back) Set Screw |
| 546586 (853) | Tension (looper, left hand) Screw Stud | 546645-002 | Oil Tube (vinyl) | 549085 (833) | Needle Bar Crank (front) Set Screw |
| 546586 (853) | Tension (looper, right hand) Screw Stud | 546645-003 | Oil Tube (vinyl) | 549138 (853) | Presser Lever Screw Stud (eccentric) |
| | | 546645-004 | Oil Tube (vinyl) | 549403 | Cloth Plate complete |
| | | 546646 | Oil Focal Point Oil Wick (5) | 549404 | Feed Dog |
| | | 546647 | Oil Tube Joint Washer (16) | 549405 | Feed Bar |
| | | 546648 | Oil Tube Clamp (8) | 549407 | Frame Rotary Shaft Cover with 546651 |
| | | 546649 | Oil Tube Holder (large) | 549408 | Feed Eccentric Cover Holder Oil Guard |
| | | 546650 | Oil Tube Holder (small) (2) | | |
| | | 546651 | Frame Rotary Shaft Cover Felt | | |
| | | 546666 | Looper (left hand) Lever Hinge Stud Oil Wick | | |
| | | 546667 | Feed Regulating Screw Stud Nut Washer | | |
| | | 546668 | Feed Bar Hinge Pin Collar with 154790 (850) | | |
| | | 546669 | Feed Eccentric Cover Holder Thumb Screw Washer | | |
| | | 546671 | Oil Flow Regulating Pin O-Ring | | |
| | | 546672 | Oil Flow Regulating Pin | | |
| | | 546675 | Looper (right hand) and Spreader Lever Connection Cover Gasket | | |

NUMERICAL LIST OF PARTS FOR MACHINE 81U71

| PART NO | DESCRIPTION |
|--------------|--|
| 549412 | Feed Eccentric Cover Holder |
| 549417 | Frame Rotary Shaft |
| 549420 | Frame Rotary Shaft Crank with 545076 (833), 549049 (833) and 546522 |
| 549423 | Guide Body |
| 549424 | Guide Finger |
| 549425 | Guide Smoothing Plate |
| 549426 | Guide Smoothing Plate Screw Washer |
| 549427 | Guide complete, Nos. 549423 to 549426, 504010 (829) and two 545180 (803) |
| 549429 | Looper (left hand) |
| 549432 | Looper (right hand) |
| 549435 | Needle Bar with 545406 (853) |
| 549436 | Needle Bar Connecting Bracket with 545071 (853) |
| 549437 | Looper (right hand) and Spreader Lever Connection with four 545077 (850) |
| 549438 | Oil Pump (screw pump) Body |
| 549439 (803) | Oil Pump (screw pump) Screw |
| 549440 | Oil Focal Point (large) |
| 549441 | Oil Focal Point (small) |
| 549442 | Needle Guard Holder |
| 549443 | Presser Foot 549444 with 549445 and 545180 (803) |
| 549444 | Presser Foot (body) |
| 549445 | Presser Foot Chaining-off Finger |
| 549447 | Thread (looper, right hand) Take-up |
| 549448 | Thread (needle) Take-up |
| 549449 | Throat Plate |
| 549450 | Lifting Lever Bracket |
| 549451 | Presser Lever |
| 549452 | Needle Guard |
| 549508 | Tension (needle thread) Thread Guide |
| 549509 | Frame Rotary Shaft Bushing (front) |
| 549510 | Tension (looper, right hand) Thread Guide |

ACCESSORIES

| | |
|--------|---------------------------------------|
| PN962 | Oiler |
| 1230 | Needle (81X5) #21 (6) |
| 545133 | Wood Screw 1" No. 11 (2) |
| 546656 | Tweezers (curved) |
| 546657 | Wrench |
| 546658 | Screw Driver (large) |
| 546660 | Foot Lifter Chain |
| 546662 | Machine Cover |
| 546663 | Foot Lifter Treadle complete |
| 546664 | Oil Can (400 cc) |
| 546689 | Screw Driver (small) |
| 546692 | Screw Driver (medium) |
| 546704 | Thread Unwinder (for three spools) |
| 547088 | Threading Wire (2) |
| 549130 | Wood Screw 1" No. 11(4) |
| 549433 | Spreader (right hand) |